

FEDS

TELESCOPIC SLIDES AND LINEAR RAILS

Partial extension
Bi directional

Slide type: **SOWST**

Note: The slide opening and the hole pattern, can be customized according customer's requirements.

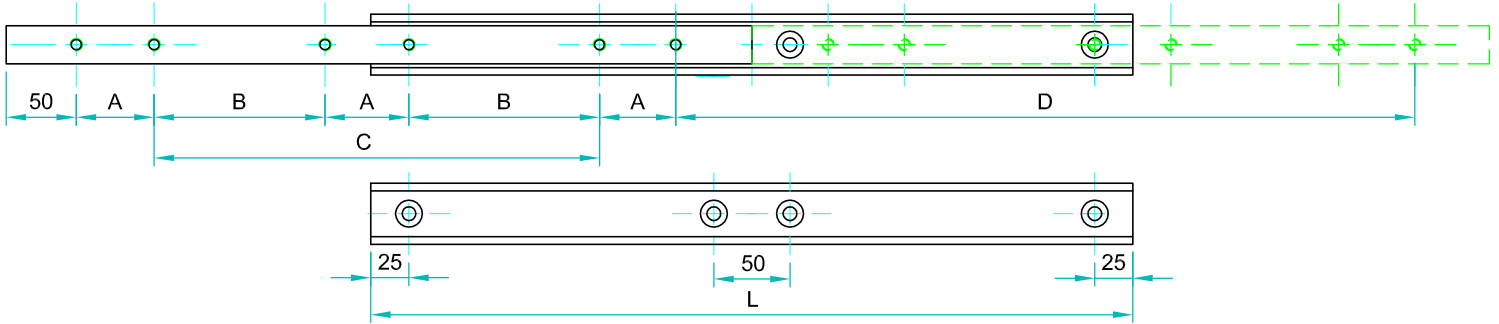

Options:

- "V" - V shape channel raceways
- "F" - one outer beam countersunk

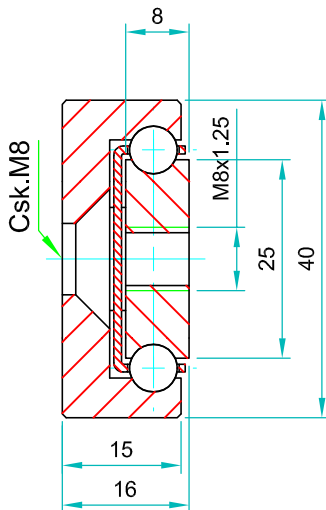

We recommend use the major axis.
Do not dismantle the slide !
The maximum safe load is given for a fully extended pair of slides, mounted on the major axis with a load spread uniformly along the inner beam
Flat mounted slide load capacities are reduced between 60-80%

Type: SOWST-40

Article number	Instalacion lenght:L	Extension lenght :D	Load per pair: kg	Hole pattern		
				"A"	"B"	"C"
SOWST4016.0200	200	200	220	50	-	-
SOWST4016.0250	250	250	230	50	-	50
SOWST4016.0300	300	300	260	50	-	100
SOWST4016.0350	350	350	250	50	-	150
SOWST4016.0400	400	400	260	50	-	200
SOWST4016.0450	450	450	270	50	-	250
SOWST4016.0500	500	500	280	50	-	300
SOWST4016.0550	550	550	270	50	150	-
SOWST4016.0600	600	600	260	50	175	-
SOWST4016.0650	650	650	250	50	200	-
SOWST4016.0700	700	700	240	50	225	-
SOWST4016.0750	750	750	225	50	250	-
SOWST4016.0800	800	800	200	50	275	-
SOWST4016.0850	850	850	185	50	300	-
SOWST4016.0900	900	900	170	50	325	-
SOWST4016.0950	950	950	155	50	350	-
SOWST4016.1000	1000	1000	140	50	375	-
SOWST4016.1050	1050	1050	130	50	400	-
SOWST4016.1100	1100	1100	120	50	425	-
SOWST4016.1150	1150	1150	110	50	450	-
SOWST4016.1200	1200	1200	100	50	475	-
SOWST4016.1250	1250	1250	90	50	500	-
SOWST4016.1300	1300	1300	80	50	525	-
SOWST4016.1350	1350	1350	70	50	550	-
SOWST4016.1400	1400	1400	60	50	575	-
SOWST4016.1450	1450	1450	50	50	600	-
SOWST4016.1500	1500	1500	40	50	625	-
SOWST4016.1550	1550	1550	30	50	650	-
SOWST4016.1600	1600	1600	20	50	675	-

Material: All stainless steel parts

Beams: 316 L, milled raceways

Ball cages: 304 stainless sheet steel .

Ball bearings: 316 L

End Bolts: A2

Maximum temperature: We recommend -40 to +200°C with low/high-temp lubrication and free movement to allow for steel expansion.

Note: The slide opening and the hole pattern, can be customized according customer's requirements.

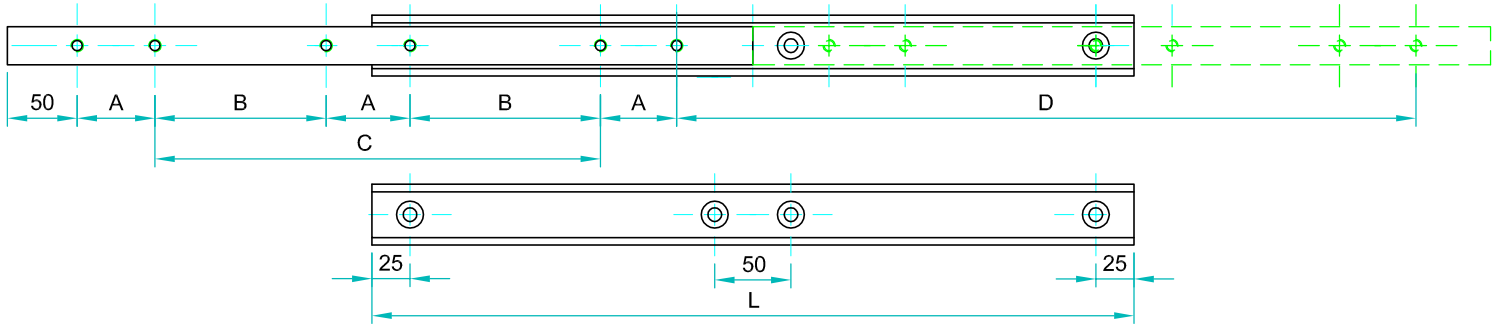

Options:
"V" - V shape channel raceways
"F" - one outer beam countersunk

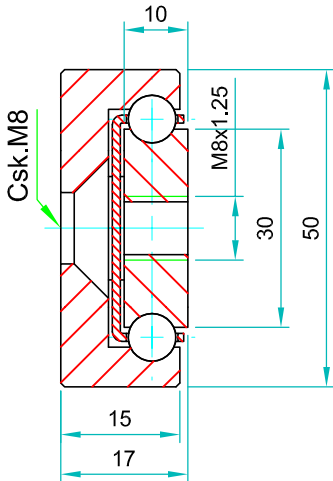

We recommend use the major axis.
 Do not dismantle the slide !
 The maximum safe load is given for a fully extended pair of slides, mounted on the major axis with a load spread uniformly along the inner beam
 Flat mounted slide load capacities are reduced between 60-80%

Type: SOWST-50				Hole pattern		
Article number	Instalacion lenght:L	Extension lenght:D	Load per pair: kg	"A"	"B"	"C"
SOWST1517.0200	200	200	330	50	-	-
SOWST1517.0250	250	250	340	50	-	50
SOWST1517.0300	300	300	350	50	-	100
SOWST1517.0350	350	350	360	50	-	150
SOWST1517.0400	400	400	370	50	-	200
SOWST1517.0450	450	450	380	50	-	250
SOWST1517.0500	500	500	390	50	-	300
SOWST1517.0550	550	550	400	50	150	-
SOWST1517.0600	600	600	380	50	175	-
SOWST1517.0650	650	650	360	50	200	-
SOWST1517.0700	700	700	340	50	225	-
SOWST1517.0750	750	750	320	50	250	-
SOWST1517.0800	800	800	310	50	275	-
SOWST1517.0850	850	850	300	50	300	-
SOWST1517.0900	900	900	290	50	325	-
SOWST1517.0950	950	950	280	50	350	-
SOWST1517.1000	1000	1000	270	50	375	-
SOWST1517.1050	1050	1050	260	50	400	-
SOWST1517.1100	1100	1100	250	50	425	-
SOWST1517.1150	1150	1150	240	50	450	-
SOWST1517.1200	1200	1200	230	50	475	-
SOWST1517.1250	1250	1250	215	50	500	-
SOWST1517.1300	1300	1300	200	50	525	-
SOWST1517.1350	1350	1350	190	50	550	-
SOWST1517.1400	1400	1400	180	50	575	-
SOWST1517.1450	1450	1450	170	50	600	-
SOWST1517.1500	1500	1500	160	50	625	-
SOWST1517.1550	1550	1550	150	50	650	-
SOWST1517.1600	1600	1600	140	50	675	-
SOWST1517.1650	1650	1650	130	50	700	-
SOWST1517.1700	1700	1700	120	100	650	-
SOWST1517.1750	1750	1750	110	100	675	-
SOWST1517.1800	1800	1800	100	100	700	-
SOWST1517.1850	1850	1850	90	100	725	-
SOWST1517.1900	1900	1900	80	100	750	-
SOWST1517.1950	1950	1950	70	100	775	-
SOWST1517.2000	2000	2000	60	100	800	-

Material: All stainless steel parts

Beams: 316 L, milled raceways

Ball cages: 304 stainless sheet steel .

Ball bearings: 316 L

End Bolts: A2

Maximum temperature: We recommend -40 to +200°C with low/high-temp lubrication and free movement to allow for steel expansion.