

**Options:**

- "V" - V shape channel raceways
- "F" - one outer beam countersunk
- "FF"- both outer beams countersunk

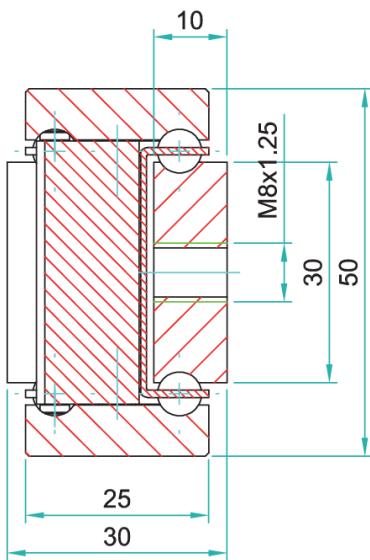

Type: ADTSB-5030 weights 3.4 kg/m				Hole pattern		
Article number	Installation length: L	Extension length: D	Load per pair: kg	"A"	"B"	"C"
ADTSB5030.0200	200	200	110	50	-	-
ADTSB5030.0250	250	250	120	50	-	50
ADTSB5030.0300	300	300	130	50	-	100
ADTSB5030.0350	350	350	140	50	-	150
ADTSB5030.0400	400	400	150	50	-	200
ADTSB5030.0450	450	450	160	50	-	250
ADTSB5030.0500	500	500	170	50	-	300
ADTSB5030.0550	550	550	180	50	150	-
ADTSB5030.0600	600	600	175	50	175	-
ADTSB5030.0650	650	650	170	50	200	-
ADTSB5030.0700	700	700	165	50	225	-
ADTSB5030.0750	750	750	160	50	250	-
ADTSB5030.0800	800	800	155	50	275	-
ADTSB5030.0850	850	850	150	50	300	-
ADTSB5030.0900	900	900	145	50	325	-
ADTSB5030.0950	950	950	140	50	350	-
ADTSB5030.1000	1000	1000	135	50	375	-



**Do not dismantle the slide!**

The maximum safe working load is stated for fully extended pair of slides, mounted upright. Use all fixing holes and spread the load evenly across the inner beam.  
 Flat mounting: Reduce the load by 60-80%.  
 We recommend the use of strong L brackets for under or floor mount.  
 Deflection is calculated up to 2% of the closed length, at or near full load capacity.

**Installation tolerance:**

Closed length Tolerance: DIN2768 – c

Extension Tolerance: DIN2768 - c

Installation width tolerance + 0.4 to – 0.6mm

Type: ADTSB-5030 weights 3.4 kg/m				Hole pattern		
Article number	Installation length: L	Extension length: D	Load per pair: kg	"A"	"B"	"C"
ADTSB5030.1050	1050	1050	130	50	400	-
ADTSB5030.1100	1100	1100	125	50	425	-
ADTSB5030.1150	1150	1150	120	50	450	-
ADTSB5030.1200	1200	1200	115	50	475	-
ADTSB5030.1250	1250	1250	108	50	500	-
ADTSB5030.1300	1300	1300	100	50	525	-
ADTSB5030.1350	1350	1350	92	50	550	-
ADTSB5030.1400	1400	1400	84	50	575	-
ADTSB5030.1450	1450	1450	76	50	600	-
ADTSB5030.1500	1500	1500	66	50	625	-
ADTSB5030.1550	1550	1550	55	50	650	-
ADTSB5030.1600	1600	1600	45	50	675	-

**Indirect Axis (Flat) Mounting:** As in the image above, reduce the load capacity by 60-80% and allow for increased deflection, or contact our engineers to request accurate FEA load analysis for OEM projects. We load rate per fully extended pair of slides on the direct axis, upright, with uniform loading across the beams, spaced 1,000mm apart. If load capacities need to be increased, or slides are fitted to extra-wide drawers, please contact us for technical advice.

**Material:**

**Beams:** EN-AW 6082 T6, anodized acc. BS1615 AA10

**Ball cages:** Stainless Steel 316L (1.4404), Laser cut profiles.

**Ball bearings:** Stainless Steel 316L (1.4404)

**End Bolts:** Stainless A2 304 (1.4301)

**Surface protection:** Anodized to BS 1615 AA10 (max length 1100mm). Lengths 1150mm+ supplied raw, non-anodized.

**Maximum temperature:** We recommend -40 to +200°C with low/high-temp lubrication and free movement to allow for steel expansion

