

Available Options:

- * **H** – Hardened raceways
- * **V** – V-shaped channel raceways
- * **SB** – Stainless steel ball bearings
- * **SC** – Stainless steel ball cages
- * **SA** – Stainless steel stopping pins and bolts
- * **S** – Entirely manufactured in stainless steel 316L

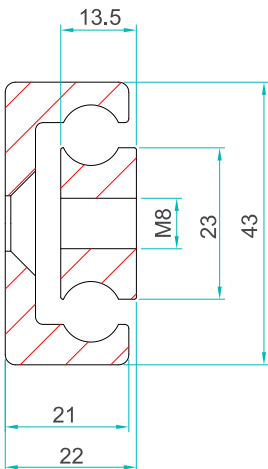

NOWS4322-A weighs 5.4 kg/m				Hole pattern		
Article number	Installation length: L	Extension length: D	Load per pair: kg	"A"	"B"	"C"
NOWS4322-A.0200	200	100	150	50	-	-
NOWS4322-A.0250	250	125	240	50	-	50
NOWS4322-A.0300	300	150	270	50	-	100
NOWS4322-A.0350	350	175	300	50	-	150
NOWS4322-A.0400	400	200	350	50	-	200
NOWS4322-A.0450	450	225	370	50	-	250
NOWS4322-A.0500	500	250	550	50	-	300
NOWS4322-A.0550	550	275	600	50	150	-
NOWS4322-A.0600	600	300	620	50	175	-
NOWS4322-A.0650	650	325	630	50	200	-
NOWS4322-A.0700	700	350	615	50	225	-
NOWS4322-A.0750	750	375	600	50	250	-
NOWS4322-A.0800	800	400	570	50	275	-
NOWS4322-A.0850	850	425	520	50	300	-
NOWS4322-A.0900	900	450	500	50	325	-
NOWS4322-A.0950	950	475	485	50	350	-
NOWS4322-A.1000	1000	500	470	50	375	-
NOWS4322-A.1050	1050	525	460	50	400	-
NOWS4322-A.1100	1100	550	445	50	425	-
NOWS4322-A.1150	1150	575	440	50	450	-
NOWS4322-A.1200	1200	600	435	50	475	-

NOWS4322-A weighs 5.4 kg/m				Hole pattern		
Article number	Installation length: L	Extension length: D	Load per pair: kg	"A"	"B"	"C"
NOWS4322-A.1250	1250	625	425	50	500	-
NOWS4322-A.1300	1300	650	415	50	525	-
NOWS4322-A.1350	1350	675	405	50	550	-
NOWS4322-A.1400	1400	700	400	50	575	-
NOWS4322-A.1450	1450	725	380	50	600	-
NOWS4322-A.1500	1500	750	360	50	625	-
NOWS4322-A.1550	1550	775	350	50	650	-
NOWS4322-A.1600	1600	800	330	50	675	-
NOWS4322-A.1650	1650	825	310	50	700	-
NOWS4322-A.1700	1700	850	300	100	650	-
NOWS4322-A.1750	1750	875	280	100	675	-
NOWS4322-A.1800	1800	900	265	100	700	-
NOWS4322-A.1850	1850	925	250	100	725	-
NOWS4322-A.1900	1900	950	235	100	750	-
NOWS4322-A.1950	1950	975	210	100	775	-
NOWS4322-A.2000	2000	1000	190	100	800	-

Installation Tolerances

Parameter	Tolerance
Closed Length	DIN 2768-c
Extension	DIN 2768-c
Installation Width	+0.4 mm / -0.6 mm

Indirect Axis (Flat) Mounting: When mounting as shown in the image above, reduce the load capacity by approximately 60–80% and account for increased deflection. For precise calculations, please contact our engineering team to request a detailed FEA load analysis tailored for OEM projects. Our standard load ratings are based on fully extended pairs of slides positioned upright (direct axis), uniformly loaded across beams spaced 1,000 mm apart. If higher load capacities are required or slides are intended for extra-wide drawers, please consult our technical support team for further guidance.

Hardened Raceway Option: Our raceways can be accurately hardened through an advanced laser process, achieving a hardness rating of 58–62 HRC without extending production lead times. This process significantly enhances tensile strength, reduces friction coefficients, minimizes operational forces, and greatly increases lifecycle performance. Load capacities for slide lengths under 700 mm show marginal improvements. Recommended operational speeds also increase to 0.6 m/s. Under standard conditions, a non-hardened Professional Range steel slide typically achieves approximately 100,000 cycles at 75% load capacity, provided correct installation, appropriate operational speeds, optimal environmental conditions, and adherence to recommended maintenance schedules are maintained (refer to the Technical Maintenance Document for additional information). Hardening the raceways to 58–62 HRC and utilizing chromed steel ball bearings substantially reduces wear and significantly extends service life. With proper maintenance and operational standards, life expectancy can exceed 500,000 cycles. While our engineers can assist OEM design programs with comprehensive FEA analysis, we highly recommend conducting in situ testing within your production facility before finalizing your design for manufacturing.

Material: All steel components.

Beams: Cold-drawn carbon steel C45E+C (EN 10277), featuring precision-milled raceways.

Ball Cages: Zinc-plated steel sheet, laser-cut profiles.

Ball Bearings: C85, G100 according to DIN 5401 standards (chromed).

End Bolts: ASTM A307 compliant.

Surface Protection: Electrolytic alkaline zinc coating (10–12 microns), compliant with DIN EN ISO 9227 neutral salt spray testing—no white rust appearance within 250 hours and no red rust appearance within 1,100 hours.

Temperature Range: Suitable for temperatures from -20°C to +250°C, provided proper lubricants are applied and beams are mounted freely to accommodate thermal expansion.

Lubrication: We apply and recommend lithium-based EP3 grease for standard applications. Special high- or low-temperature greases are available upon request.

Clean Room Requirements: Slides can be delivered unlubricated, allowing customers to perform sterilization and apply specialized greases post-production.

Thread Pitches: Coarse, as specified in the end profile image.



Important Safety Notice

Do not disassemble the slide!

The stated maximum safe working load applies to a fully extended pair of slides mounted in the upright position. Ensure all provided fixing holes are utilized, and distribute the load evenly along the inner beam. Slide deflection is calculated at a maximum of 2% of the slide's closed length when operating at or near full load capacity.

